



19 Desmond Rochford Way, Bishops Hull, Taunton TA1 5FF

£264,000

GIBBINS RICHARDS 
Making home moves happen

End of terrace *Three bedrooms *Parking for two cars

A beautifully presented three bedroomed end of terrace home ideally situated in the highly sought after Bishops Hull area of Taunton and within the desirable Castle school catchment. The property has been exceptionally well maintained by the current owners and benefits from two parking spaces to the front, offering ready to move in accommodation.

Tenure: Freehold / Energy Rating: B / Council Tax Band: C

The property benefits from a welcoming entrance hall with cloakroom, a comfortable sitting room and well proportioned kitchen/diner with patio doors opening to a private rear garden. On the first floor are three bedrooms including a spacious principle bedroom with an en-suite as well as a modern family bathroom. Externally the property features a private rear garden and two parking spaces at the front, it also enjoys lovely views over the nearby playing fields and surrounding countryside.

67.0 Approximate square meters

End of terrace three bedroomed home

Popular village location in Bishops Hull

Beautifully maintained

Fantastic starter home

Gas central heating

Parking for two cars

Enclosed private garden

Castle school catchment





Entrance Hall

Cloakroom 5' 6" x 3' 1" (1.68m x 0.94m)

Sitting Room 14' 3" x 12' 1" (4.34m x 3.68m) including bay window.

Kitchen/Diner 15' 3" x 8' 9" (4.64m x 2.66m)

First Floor Landing

Bedroom 1 12' 1" x 9' 6" (3.68m x 2.89m)

En-suite 6' 4" x 5' 1" (1.93m x 1.55m)

Bedroom 2 9' 8" x 7' 8" (2.94m x 2.34m)

Bedroom 3 7' 7" x 5' 9" (2.31m x 1.75m)

Bathroom 6' 5" x 5' 9" (1.95m x 1.75m)

Outside Private rear garden and two parking spaces at the front.



GROUND FLOOR
368 sq.ft. (34.2 sq.m.) approx.

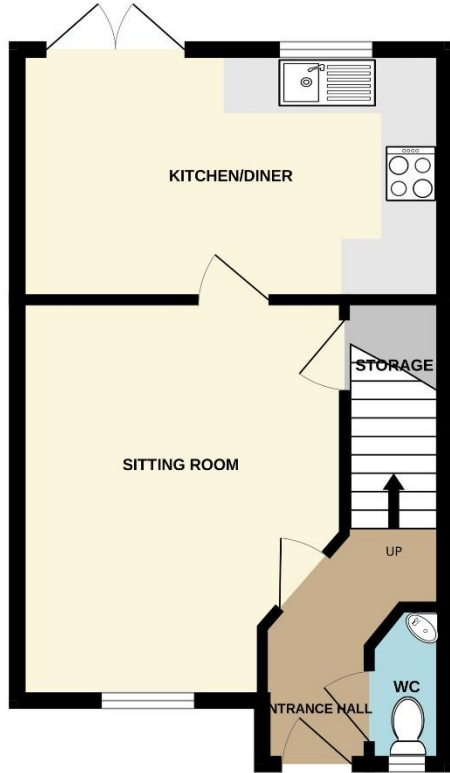

1ST FLOOR
353 sq.ft. (32.8 sq.m.) approx.

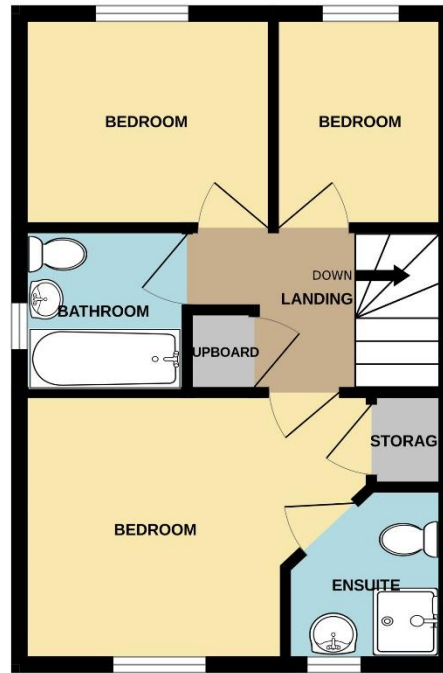

TOTAL FLOOR AREA : 721 sq.ft. (67.0 sq.m.) approx.

Whilst every attempt has been made to ensure the accuracy of the floorplan contained here, measurements of doors, windows, rooms and any other items are approximate and no responsibility is taken for any error, omission or mis-statement. This plan is for illustrative purposes only and should be used as such by any prospective purchaser. The services, systems and appliances shown have not been tested and no guarantee as to their operability or efficiency can be given.
Made with Metropix ©2026

The Agent has not tested any apparatus, equipment, fixtures and fittings or services and so cannot verify that they are in working order or fit for the purpose. A Buyer is advised to obtain verification from their Solicitor or Surveyor. References to the Tenure of a Property are based on information supplied by the Seller. The Agent has not had sight of the title documents. A Buyer is advised to obtain verification from their Solicitor.

Items shown in photographs are NOT included unless specifically mentioned within the sales particulars. They may however be available by separate negotiation. Buyers must check the availability of any property and make an appointment to view before embarking on any journey to see a property.



We routinely refer potential sellers and purchasers to a selection of recommended conveyancing firms – both local and national. It is their decision whether to use those services. In making that decision, it should be known that we receive a payment benefit of not more than £200 per transaction. We routinely refer potential sellers and purchasers to Mortgage Advice Bureau (MAB) for mortgage and protection advice. It's their decision whether to use those services. In making that decision, it should be known that we receive a payment benefit of not more than £250 per case. Once an offer is accepted by our client, an Administration Fee of £40 + VAT (£48) per buyer will be required in order for us to process the necessary checks relating to our compliance and Anti-Money Laundering obligations. This is a non-refundable payment and cannot be returned should a purchase cease to continue. It can be paid via a card machine, or via BACS transfer.